

23rd Street

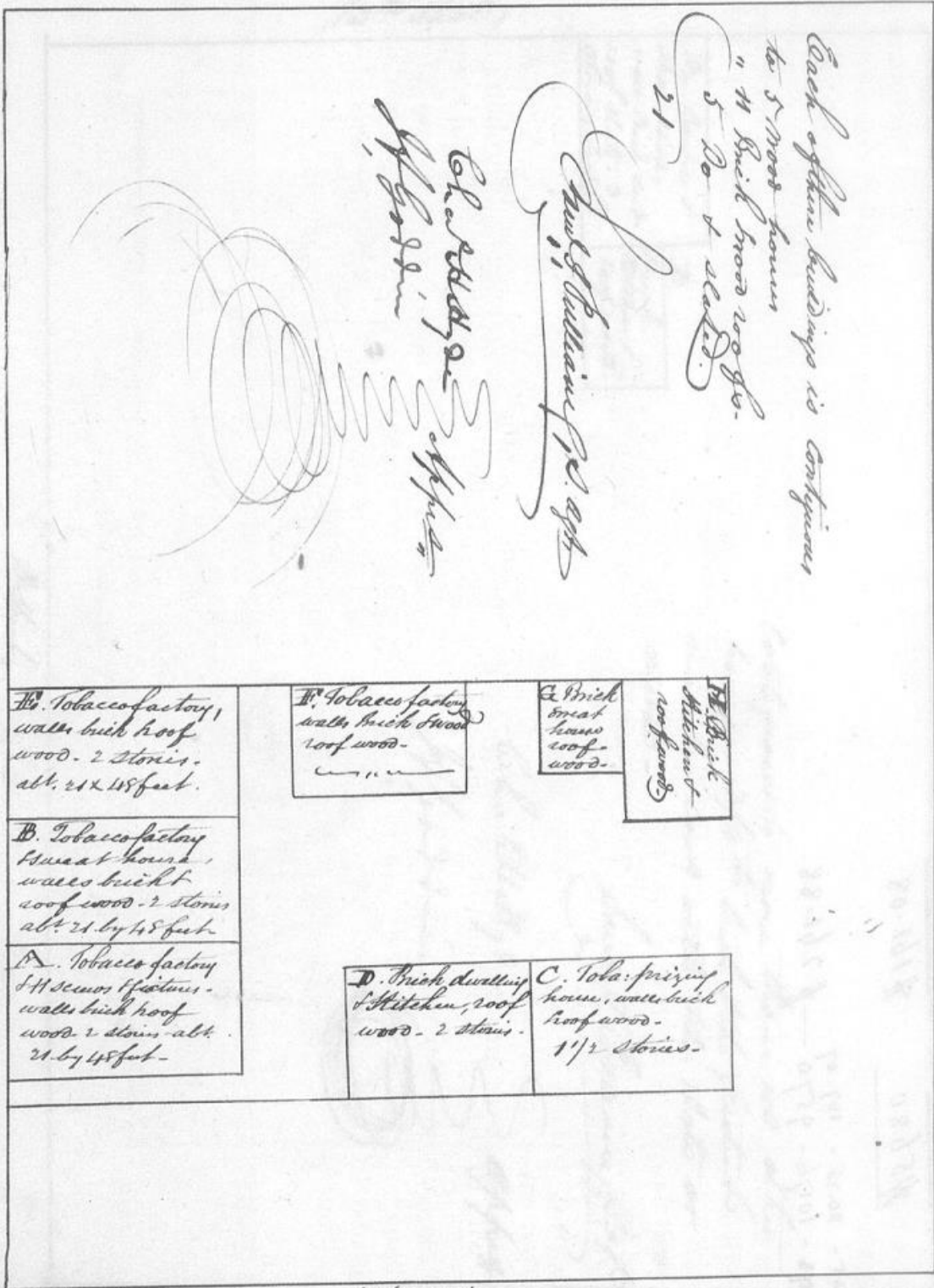

Main or Center

Each of these buildings is contiguous
to 5th cross town
" 4th brick cross road
5th Do & 23rd.

21

John G. Sullivan P.O. 1875

John G. Sullivan P.O. 1875

H. Tobacco factory,
walls brick roof
wood. 2 stories.
abt. 21 x 118 feet.

F. Tobacco factory
walls brick roof
wood.

G. Brick
dwelling
kitchen &
roof wood.

B. Tobacco factory
dwelling house,
walls brick
roof wood. 2 stories
abt. 21 by 118 feet.

D. Tobacco factory
dwelling house.
walls brick roof
wood. 2 stories. abt.
21 by 118 feet.

D. Brick dwelling
& kitchen, roof
wood. 2 stories.

C. Tobacco mixing
house, walls brick
roof wood.
1 1/2 stories.

23rd Street

24th Street

24th Street